

P E R M I T

CITY OF NAPOLEON  
255 W. RIVERVIEW AVE  
NAPOLEON, OHIO 43545

DIVISION OF BUILDING & ZONING  
PH (419) 592-4010  
FAX (419) 599-8393

PERMIT NO: 960008

DATE ISSUED: 11-15-96

ISSUED BY: BND

JOB LOCATION: 1108 W RIVERVIEW AVE

EST. COST: 6000.00

LOT #:

SUBDIVISION NAME:

OWNER: BURK, JO  
ADDRESS: 1108 W RIVERVIEW  
CSZ: NAPOLEON, OH 43545  
PHONE: 419-592-5651

AGENT: JOHN LIGHT BLDRS.  
ADDRESS: 1-918 US HWY 6  
CSZ: MCCLURE, OH 43534  
PHONE: 419-748-8803

USE TYPE - RESIDENTIAL: X

OTHER:

ZONING INFORMATION

DIST: LOT DIM: AREA: FYRD: 30 SYRD: 7 RYRD: 15  
MAX HT: 40 # PKG SPACES: # LOADING SP: MAX LOT COV: 35%

BOARD OF ZONING APPEALS:

WORK TYPE - NEW: REPLMNT: ADD'N: X ALTER: REMODEL: X

WORK INFORMATION

SIZE - LGTH: 21 WIDTH: 7 STORIES: 1 LIVING AREA SF: 147  
RAGE AREA SF: HEIGHT: 10 BLDG VOL DEMO PERMIT:

WORK DESCRIPTION

NEW SIDING, TWO WINDOWS, & PATIO ENCLOSURE

FEE DESCRIPTION

PAID DATE

FEE AMOUNT DUE

BUILDING PERMIT

11-25-96

49.00

TOTAL FEES DUE

49.00

-----  
DATE

-----  
APPLICANT SIGNATURE

P E R M I T

CITY OF NAPOLEON  
255 W. RIVERVIEW AVE  
NAPOLEON, OHIO 43545

DIVISION OF BUILDING & ZONING  
PH (419) 592-4010  
FAX (419) 599-8393

PERMIT NO: 960008      DATE ISSUED: 11-15-96      ISSUED BY: BND  
JOB LOCATION: 1108 W RIVERVIEW AVE      EST. COST: 6000.00

LOT #:      SUBDIVISION NAME:

OWNER: BURK, JO  
ADDRESS: 1108 W RIVERVIEW  
CSZ: NAPOLEON, OH 43545  
PHONE: 419-592-5651

AGENT: JOHN LIGHT BLDGS.  
ADDRESS: 1-918 US HWY 6  
CSZ: MCCLURE, OH 43534  
PHONE: 419-748-8803

USE TYPE - RESIDENTIAL: X

OTHER:

ZONING INFORMATION

DIST:      LOT DIM:      AREA:      FYRD: 30      SYRD: 7      RYRD: 15  
MAX HT: 40      # PKG SPACES:      # LOADING SP:      MAX LOT COV: 35%

BOARD OF ZONING APPEALS:

WORK TYPE - NEW:      REPLMNT:      ADD'N: X      ALTER:      REMODEL: X

WORK INFORMATION

SIZE - LGTH: 21      WIDTH: 7      STORIES: 1      LIVING AREA SF: 1.47  
GARAGE AREA SF:      HEIGHT: 10      BLDG VOL DEMO PERMIT:

WORK DESCRIPTION

NEW SIDING, TWO WINDOWS, & PATIO ENCLOSURE

FEE DESCRIPTION

PAID DATE

FEE AMOUNT DUE

BUILDING PERMIT

49.00

TOTAL FEES DUE

49.00

*11-25-96*  
DATE  
*Footer 11-25-96*  
*Final 12/16/96*

*[Handwritten Signature]*

APPLICANT SIGNATURE

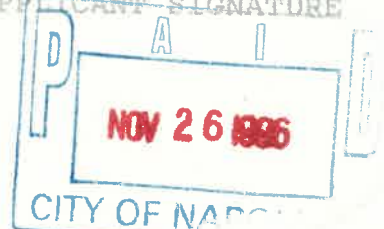

Joe Burke  
110 & River View  
Napoleon, OH

748-8803

JOHN LIGHT (BUILDER)  
1-918-456  
MCCLURE, OHIO 43534

49.00

Called John  
11-22-96 that double top paper  
is required w/ 1/4" over  
concrete over existing  
ground

2' x 8" w/ 1/2" plywood br-tween  
& glued and 20d spikes)

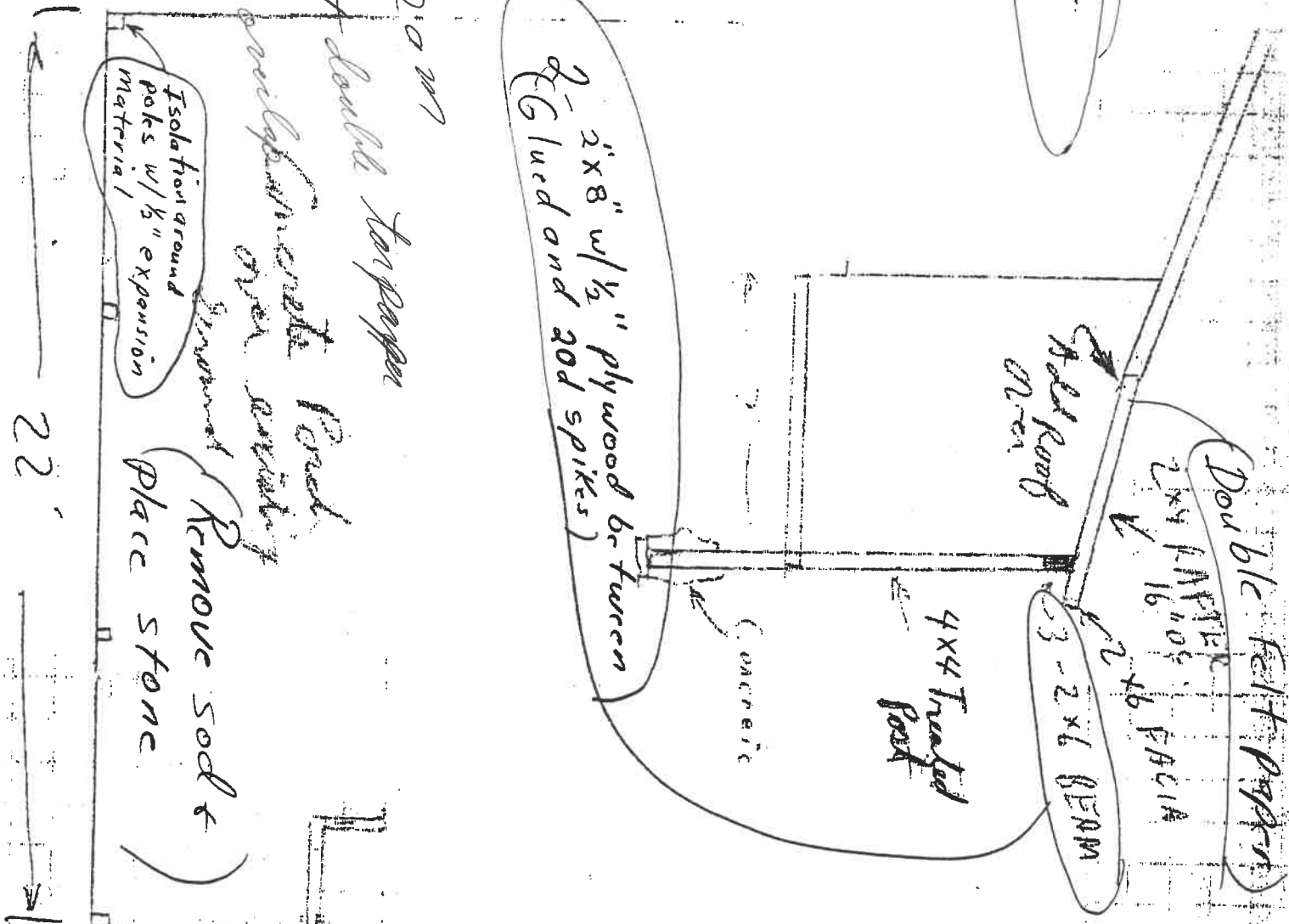

Isolation ground poks w/ 1/8" expansion material

Remove sod & place stone

22'

CITY OF NAPOLEON INSPECTION FORM

January 22, 1997

PERMIT #: 960008

JOB LOCATION: 1108 W RIVERVIEW AVE

OWNER: BURK, JO

WORK DESCRIPTION: NEW SIDING, TWO WINDOWS, & PATIO ENCLOSURE

PLUMBING:    UNDGR \_\_\_\_\_    RGHIN \_\_\_\_\_    FINAL \_\_\_\_\_

MECHANICAL:   UNDGR \_\_\_\_\_    RGHIN \_\_\_\_\_    FINAL \_\_\_\_\_

ELECTRICAL:   UNDGR \_\_\_\_\_    RGHIN \_\_\_\_\_    FINAL \_\_\_\_\_

BUILDING:    SITE \_\_\_\_\_    FTG \_\_\_\_\_    FNDDT \_\_\_\_\_

STRUC \_\_\_\_\_    ROOF \_\_\_\_\_    EXT \_\_\_\_\_    VENT \_\_\_\_\_

ACCESS \_\_\_\_\_    SMKDT \_\_\_\_\_    FINAL 12-17-96 OCCP \_\_\_\_\_

MISC INSP: \_\_\_\_\_

NOTES: \_\_\_\_\_

\_\_\_\_\_

\_\_\_\_\_